

CIVIL AND ELECTRICAL WORK TO BE COMPLETED

BY

STATE GOVERNMENT

The proposed PoPs of Tripura State Wide Area Network (Tripura SWAN) is expected to provide reliable and 24X7 basis data communication services to various line departments for e-Governance services in the State of Tripura. Considering the fact that each PoP shall form backbone of different e-governance applications which demands high availability. Hence, each PoP Centre must be free from dampness, seepage of water / flood etc. There would be 65 PoPs in the state of Tripura at different layers.

Sample Electrical wiring (Layout) is enclosed with indicative cost estimate for ready reference.

1. IDENTIFICATION OF PoP Centre

1. Typical room size of 20 ft x 20 ft for setting up PoP Centre for effective operation and maintenance.

2. CIVIL WORK

1. Civil work to be done wherever required avoiding dampness, seepage of water.
2. Smooth cemented plaster on walls and PVC flooring is required.
3. A false ceiling at the height of 10 feet should be made
4. It is required to have Aluminum sliding doors with glass fittings.

3. ELECTRICAL WORK

1. One split type Air Conditioners of 2 Tons should be fitted in the PoP.
2. One diesel/petrol generator of 5 KVA is to be provided with necessary electric wiring
3. Proper earthing for all the equipments is to be ensured. Please ensure that Ground to neutral voltage is less than 2 volts.
4. Fire security measures should be taken care of and fire extinguisher(s) should be installed.

*Site Preparation Guidelines for PoP*

4. INTERIORS

1. Door, windows and walls to be painted.

5. MISCELLENEOUS

1. Lock and Key arrangement of the PoP Centre for safety of the equipment
2. Suitable Security Guard to be provided by the State Government round the clock.

6. RECURRING EXPENSES:

1. The State Government will be bearing all running expenditure like electricity bill, diesel/petrol to be provided, telephone bills, consumables etc.

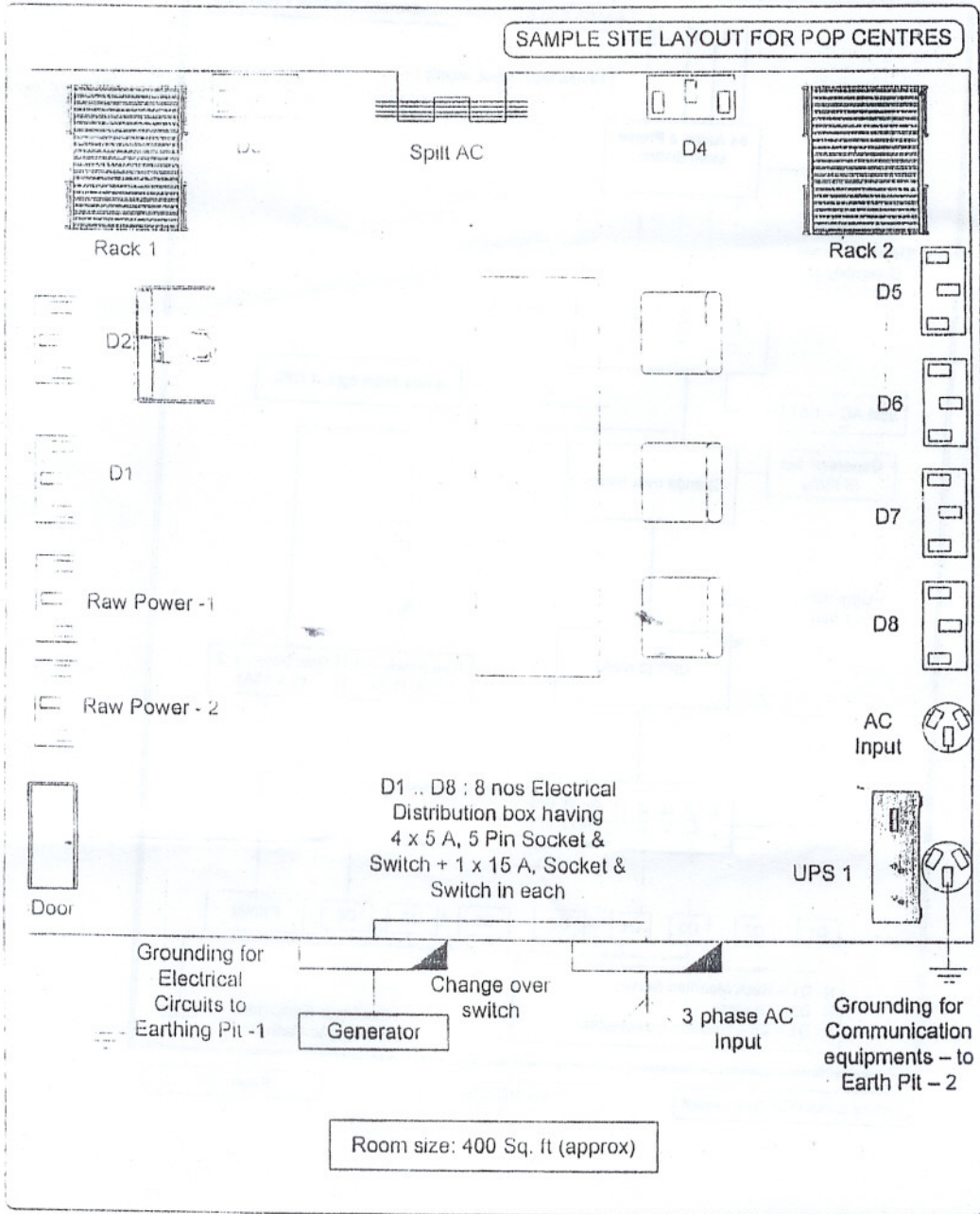

Site Preparation Guidelines for PoP

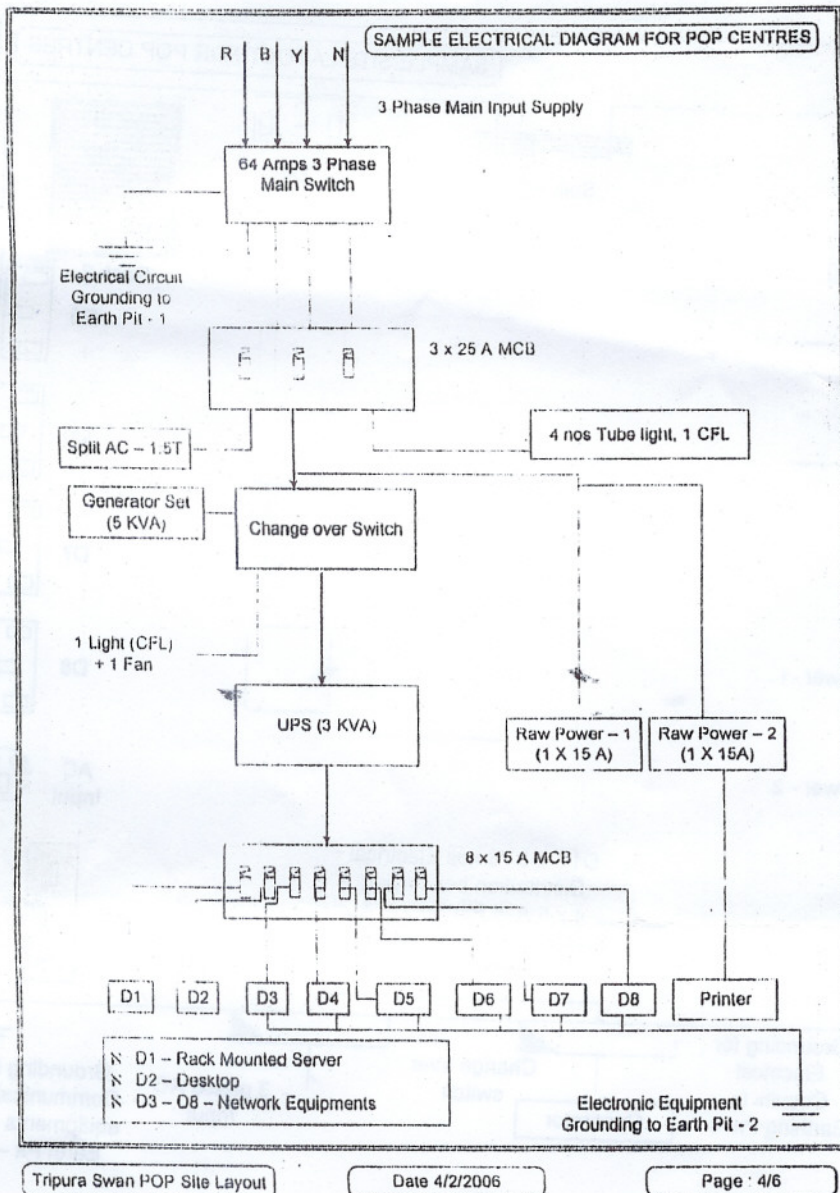

Indicative Estimate for Site Preparation- SWAN PoP Centre					
Sl	Description	Qty	Rate (INR)	Amount	Remarks
1	<b>Electrical Items:</b>				
1.1	64 A, 3 Ph Main Switch	1	3000	INR 3,000.00	
1.2	32 A, Single Phase Changeover Switch	1	2500	INR 2,500.00	For Generator Connection
1.3	Distribution Box	2	500	INR 1,000.00	1 for Mains distribution and 1 for UPS output distribution
1.4	32 A SP MCB	3	200	INR 600.00	1 each for 3 Phases
1.5	15 A SP MCB	6	200	INR 1,200.00	1 each for each distribution box
1.6	25 A DP Switch	2	200	INR 400.00	One for UPS input and one for UPS output
1.7	5 A, 5 Pin Socket	32	15	INR 480.00	(4 each in Distribution Box)
1.8	5 A, 5 Pin Switch	32	15	INR 480.00	(4 each in Distribution Box)
1.9	15 A Socket + Switch	8	100	INR 800.00	One in each distribution box.
1.1	15 A Socket + Switch	2	100	INR 200.00	For Raw Power.
1.11	Formica Box of various sizes	14	100	INR 1,400.00	
1.12	Electric Wires of various sizes	LS		INR 5,000.00	
1.13	Fitting & Fixing Charge	LS		INR 10,000.00	
	<b>SUB TOTAL</b>			<b>INR 27,060.00</b>	
2	<b>General Lighting:</b>				For Lights and Fan
2.1	CFL Light	2	300	INR 600.00	
2.2	Tube Light	4	200	INR 800.00	
2.3	Fan	1	2500	INR 2,500.00	
2.4	5 A Switch	7	20	INR 140.00	
2.5	Electrical Wire	LS		INR 2,000.00	
2.6	Formica box of various sizes	8	100	INR 800.00	For fitting of CFLs, Tubes and switches
	<b>SUB TOTAL</b>			<b>INR 6,840.00</b>	
3	<b>Earthing Pit -1</b>	1	10000	<b>INR 10,000.00</b>	
4	<b>Earthing Pit -2</b>	1	10000	<b>INR 10,000.00</b>	

Site Preparation Guidelines for PoP

5	Lightening Arrestor	1	12000	INR 12,000.00	
6	<b>Air Conditioning:</b>				
6.1	Split Type Airconditioner(2 Ton)	1	50000	INR 50,000.00	
6.2	Industrial Socket	1	500	INR 500.00	
6.3	Formica Box	1	100	INR 100.00	
	<b>SUB TOTAL</b>			<b>INR 50,600.00</b>	
7	<b>Sitting Arrangement:</b>				
7.1	Office Table	2	3000	INR 6,000.00	
7.2	Revolving Chair with arm rest	3	3500	INR 10,500.00	
7.3	Computer Table (Godrej:Buddy)	2	3000	INR 6,000.00	
7.4	Computer Chair without Arm rest	2	3000	INR 6,000.00	
	<b>SUB TOTAL</b>			<b>INR 28,500.00</b>	
8	<b>Civil Works:</b>				
8.1	Fitting & Fixing of Anodised Steel & Glass Door	1			
8.2	Door Closure fitting	1			
8.3	False ceiling	LS			
8.4	Miscellaneous including minor repair, closing of windows etc.	LS			
8.5	Painting with Acrylic Plastic Emulsion	LS			
8.6	Fitting & fixing of PVC Floor Tiles	LS			
	<b>SUB TOTAL</b>	LS		<b>INR 30,000.00</b>	
9	5 KVA Generator	LS		<b>INR 45,000.00</b>	

Site Preparation Guidelines for PoP

2  
58

10	Fire Extinguisher	LS		INR 5,000.00
	TOTAL			INR 225,000.00
			(Rupees two lakh and twenty five thousand only)	
	*LS- Lumpsum			